

END DRIVE, OVER HEAD, RIGHT HAND SIDE
SHBZ - STEEL HINGED BELT CONVEYOR, Z SHAPE

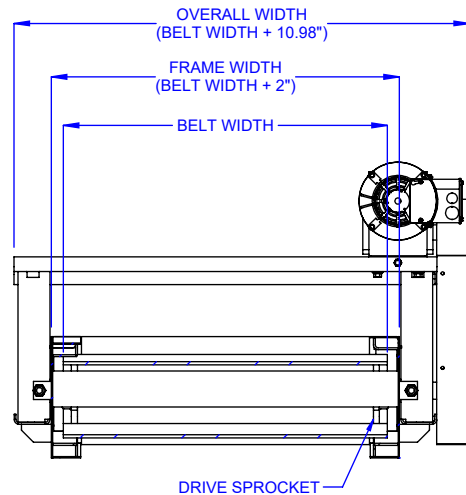

SECTION A-A
DRIVE END

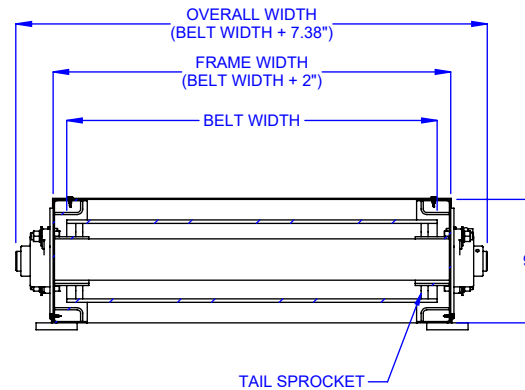

SECTION B-B
TAIL END

SPECIFICATIONS

BELT WIDTH: 8" - 36"

BEGINNING ELEVATION: 8" - 48"

LENGTH OF INCLINE: 52" - 324"

ENDING ELEVATION: 36" - 126"

SPEED: 10 - 45 FPM

INCLINED ANGLE: 30°, 45°, 60°

FEEDER LENGTH: 12" - 120"

NOSEOVER LENGTH: 15" - 120"

BELT: Standard is 2-1/2" pitch steel hinge, dimpled, standard chain with outer side bars. Optional belts are dimpled or perforated, with or without outer side bars. Optional 1-1/2" steel cleats at various center distances are available.

DRIVE: Standard drive is end drive, overhead, right hand side.

CONVEYOR MOTOR: 1/2 HP to 2 HP, 230/460V/ 3Ph/ 60Hz, TEFC, Inverter-Duty

FRAME COLOR: Powder coated blue (RAL 5017). All guarding is yellow (RAL 1023) and moving parts are bright red orange (RAL 2008). Other color options available.

MODEL: SHBH, SHBL, SHBZ

DESCRIPTION: STEEL HINGED BELT CONVEYOR

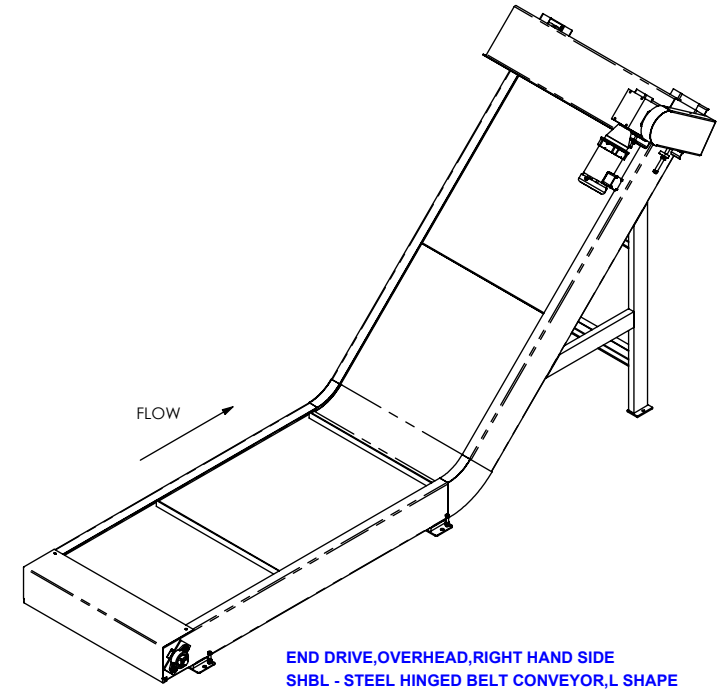
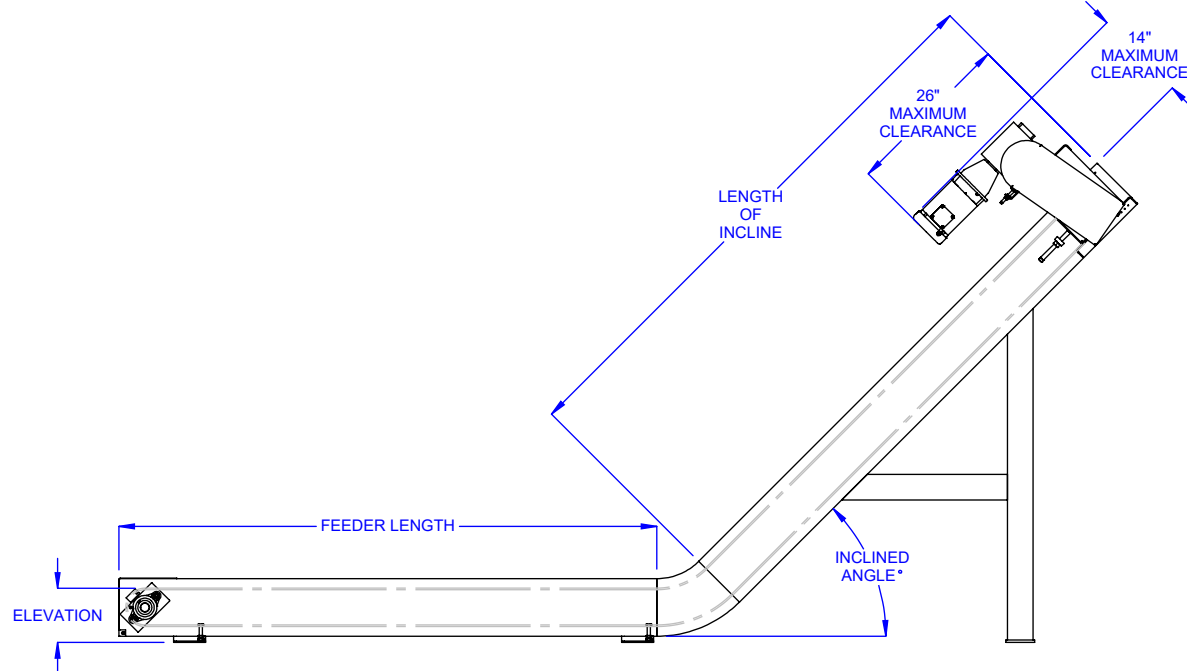
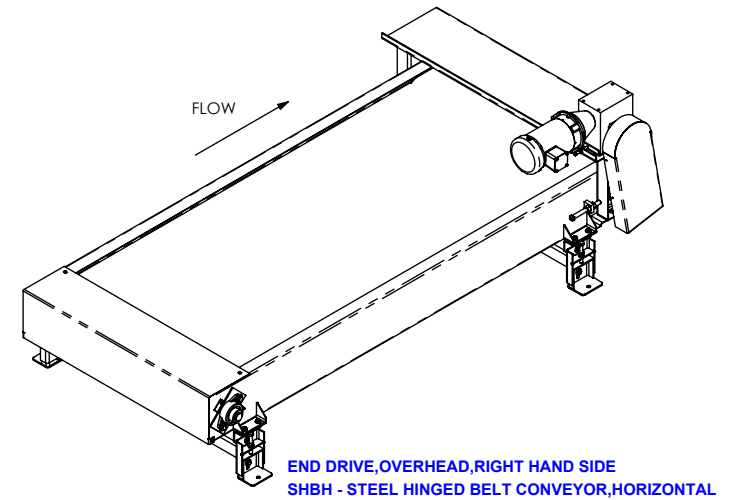
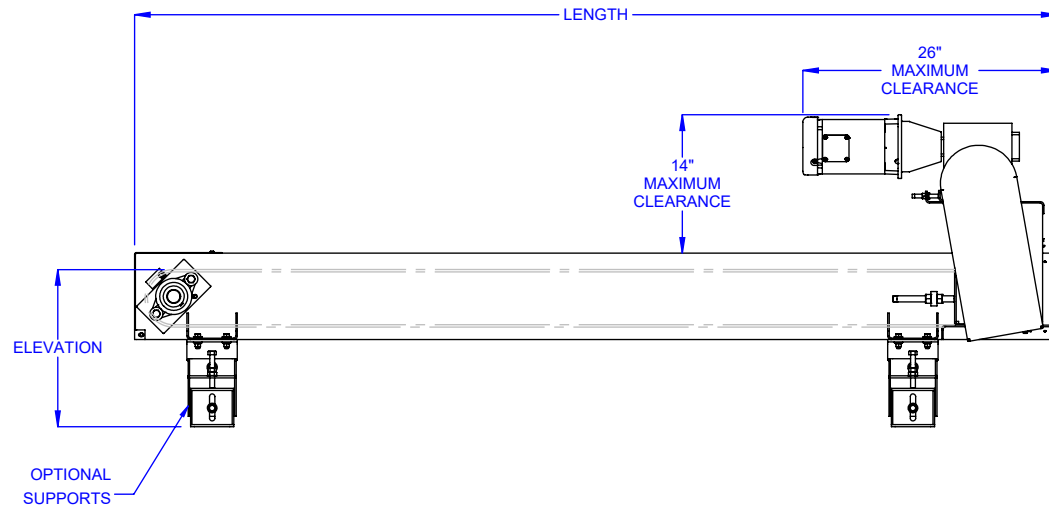

MODEL: SHBH, SHBL, SHBZ

DESCRIPTION: STEEL HINGED BELT CONVEYOR