

LOAD RATING:
 PLATFORM: 130 PSF
 STAIRWAY: 100 PSF

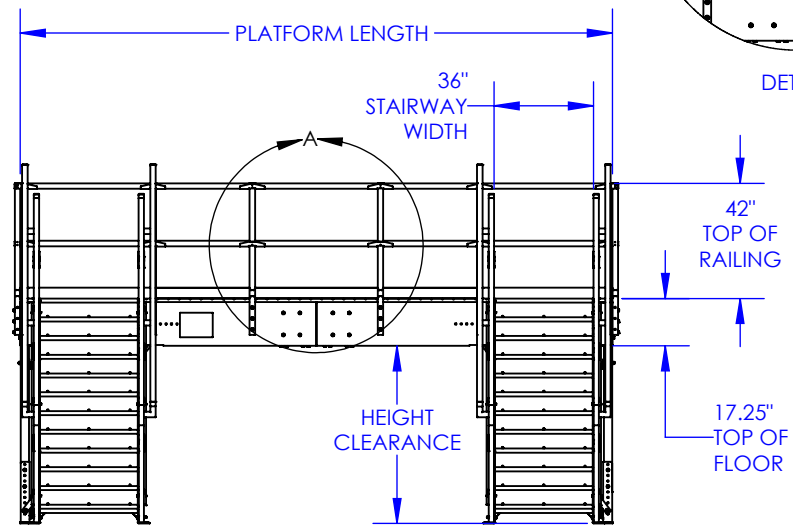
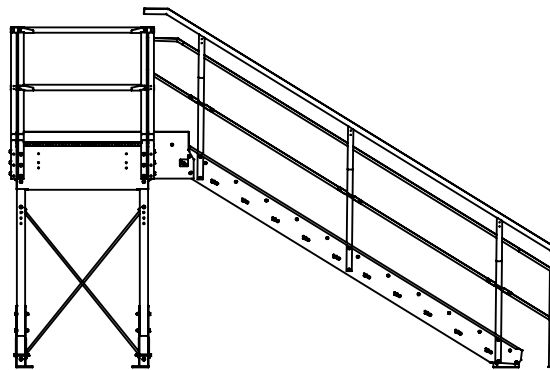
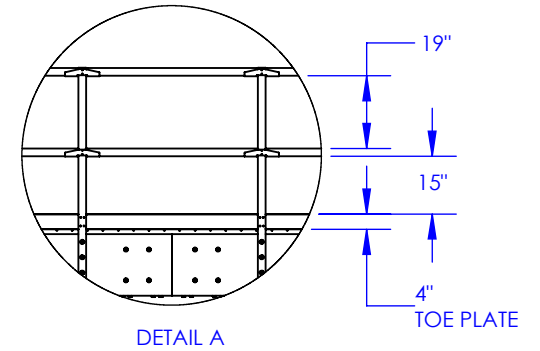
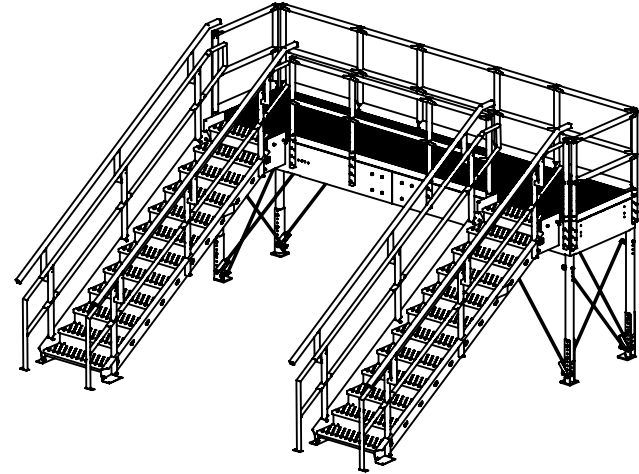
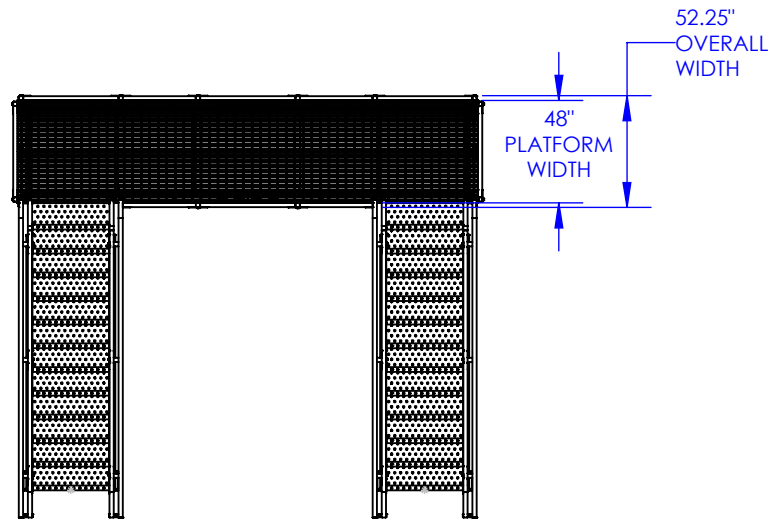

MODEL: LC2

CONFIGURATION: "U" SHAPE

DESCRIPTION: CONVEYOR CROSSOVER, 2-STAIRWAYS, U-SHAPE

LOAD RATING:
PLATFORM: 130 PSF
STAIRWAY: 100 PSF

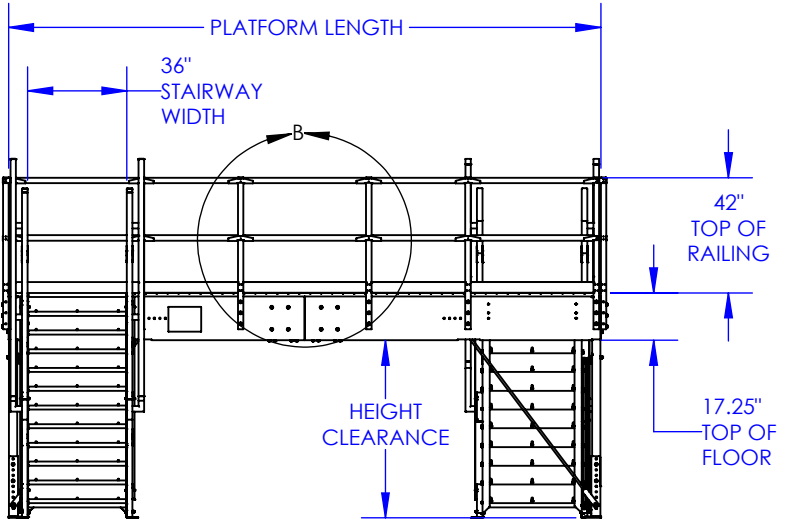
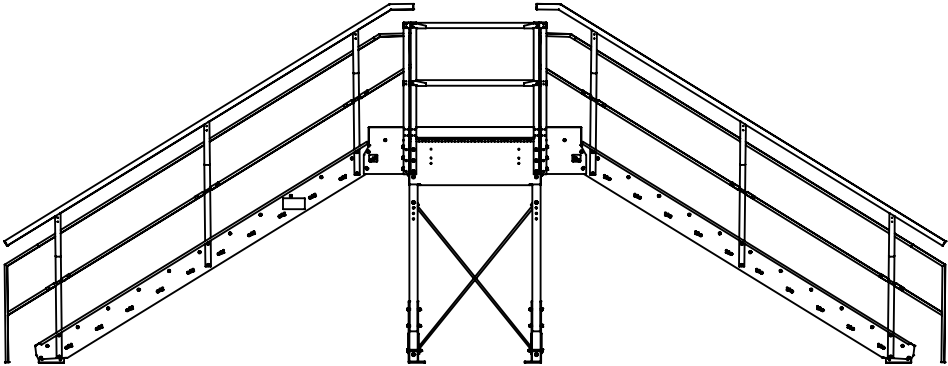
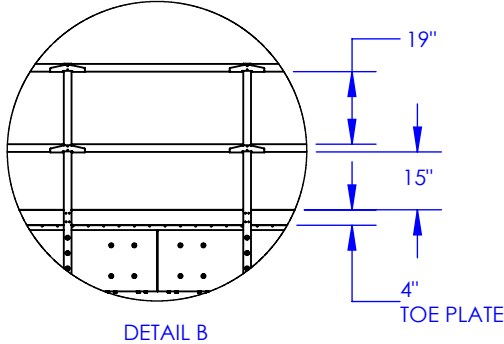
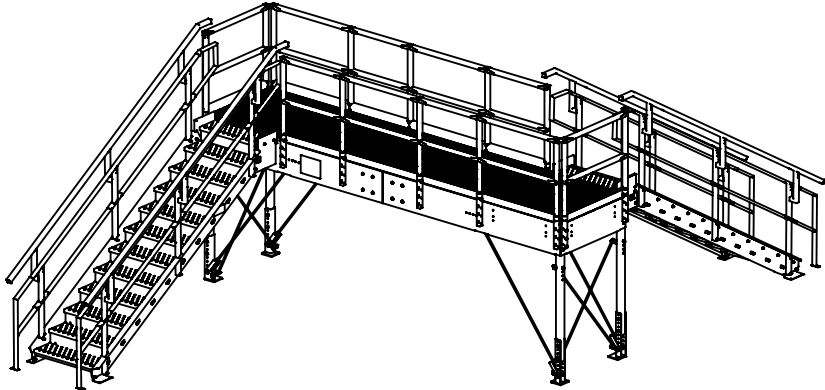
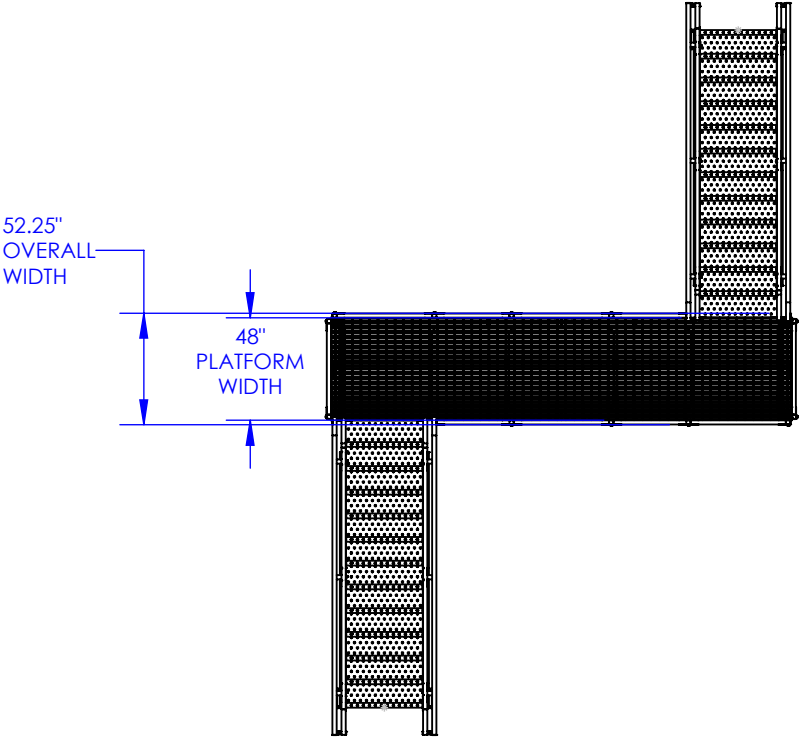

MODEL: LC2 CONFIGURATION: "Z" SHAPE

DESCRIPTION: CONVEYOR CROSSOVER, 2-STAIRWAYS, S-SHAPE

LOAD RATING:
PLATFORM: 130 PSF
STAIRWAY: 100 PSF

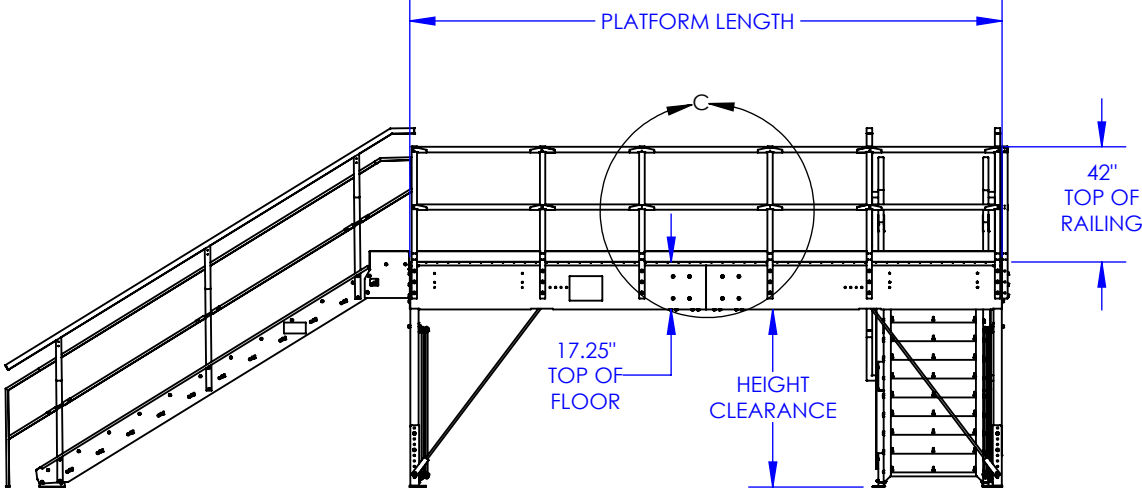
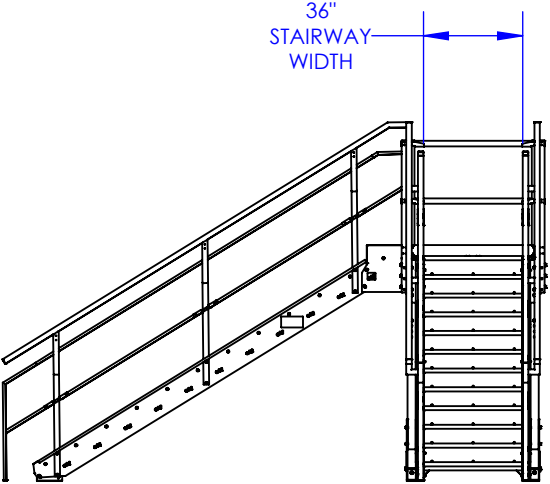
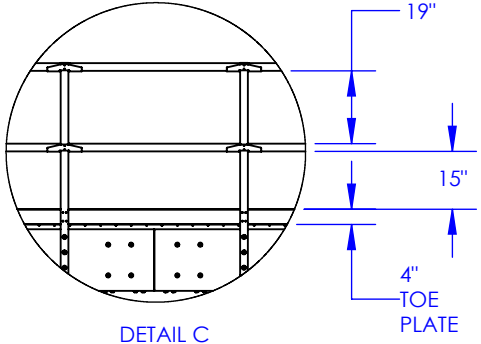
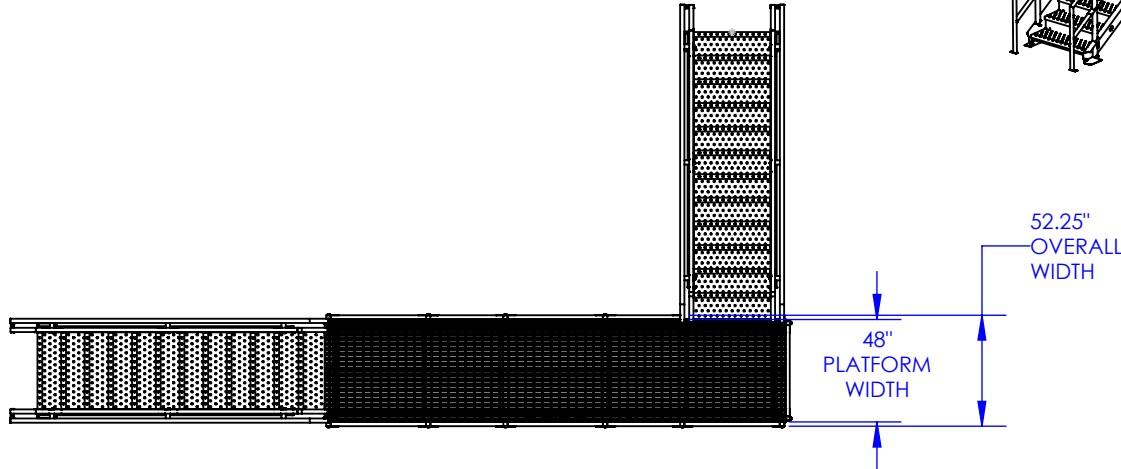
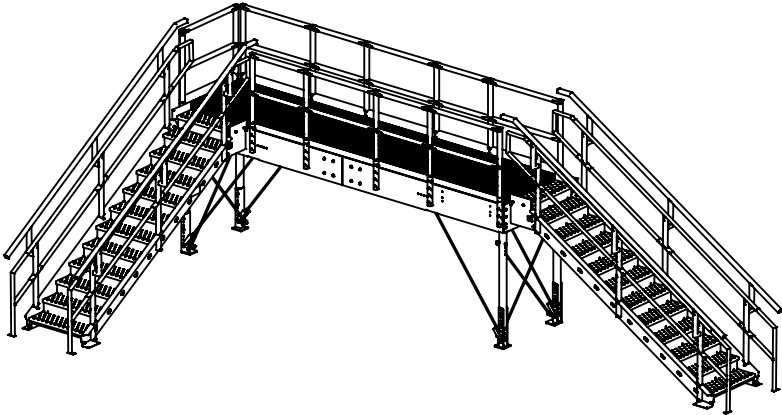

LOAD RATING:
 PLATFORM: 130 PSF
 STAIRWAY: 100 PSF

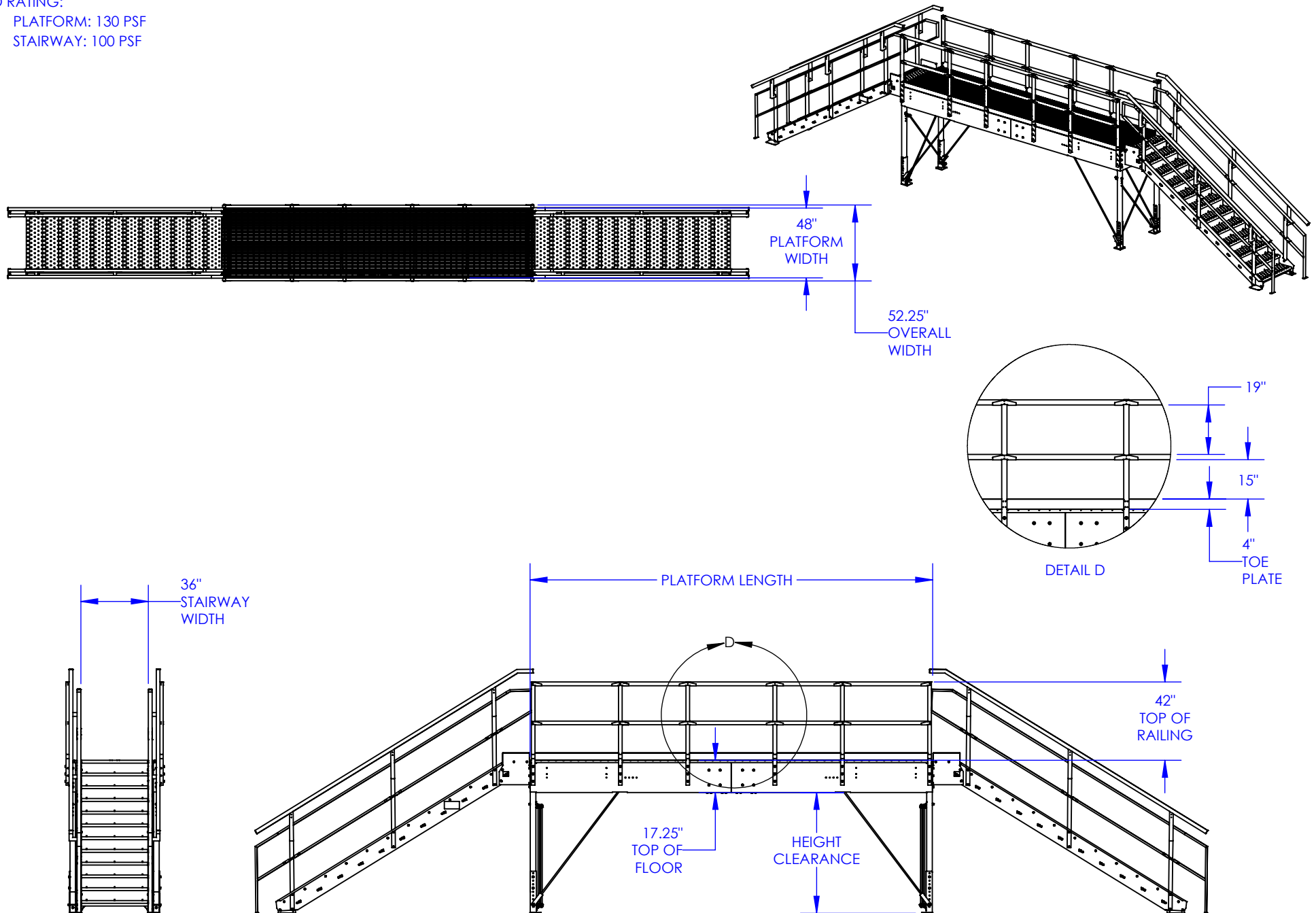

MODEL: LC2
 DESCRIPTION: CONVEYOR CROSSOVER, 2-STAIRWAYS, I-SHAPE
 CONFIGURATION: "I" SHAPE

LEWCO, INC. IS COMMITTED TO CONTINUOUS
 IMPROVEMENT AND RESERVES THE RIGHT TO CHANGE
 DESIGNS AND SPECIFICATIONS WITHOUT NOTICE.

THIS DRAWING MUST NOT BE COPIED, REPRODUCED OR
 USED FOR ANY PURPOSE WITHOUT THE WRITTEN
 CONSENT OF LEWCO, INC. ALL RIGHTS RESERVED.

LEWCO

706 LANE ST. SANDUSKY, OH 44870, U.S.A.

PLATFORM HEIGHT CLEARANCE (IN)	TOP OF FLOOR (IN)	STAIRWAY LENGTH (IN)	ANGLE (DEGREES)	TREAD DEPTH (IN)	RISER HEIGHT (IN)
54.75	72	152.43	27.4	11.58	6.00
56.75	74	151.48	28.2	11.49	6.17
58.75	76	150.49	29.1	11.40	6.33
60.75	78	149.47	29.9	11.30	6.50
62.75	80	148.41	30.8	11.21	6.67
64.75	82	147.31	31.6	11.10	6.83
66.75	84	146.18	32.5	11.00	7.00

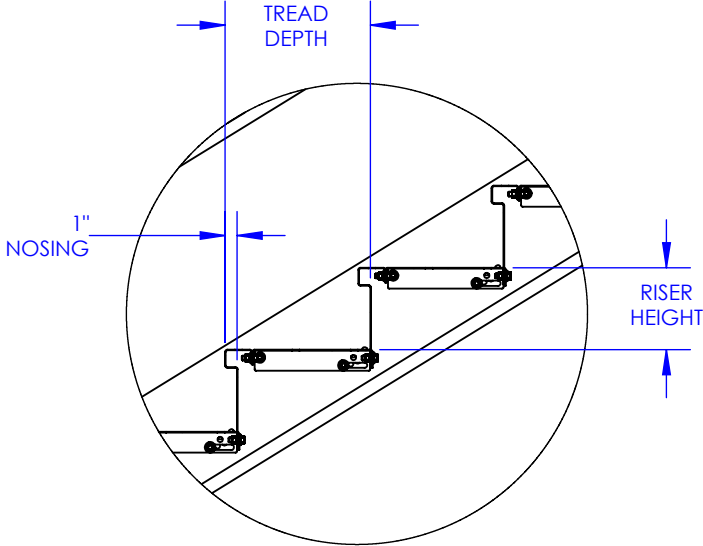

DETAIL F

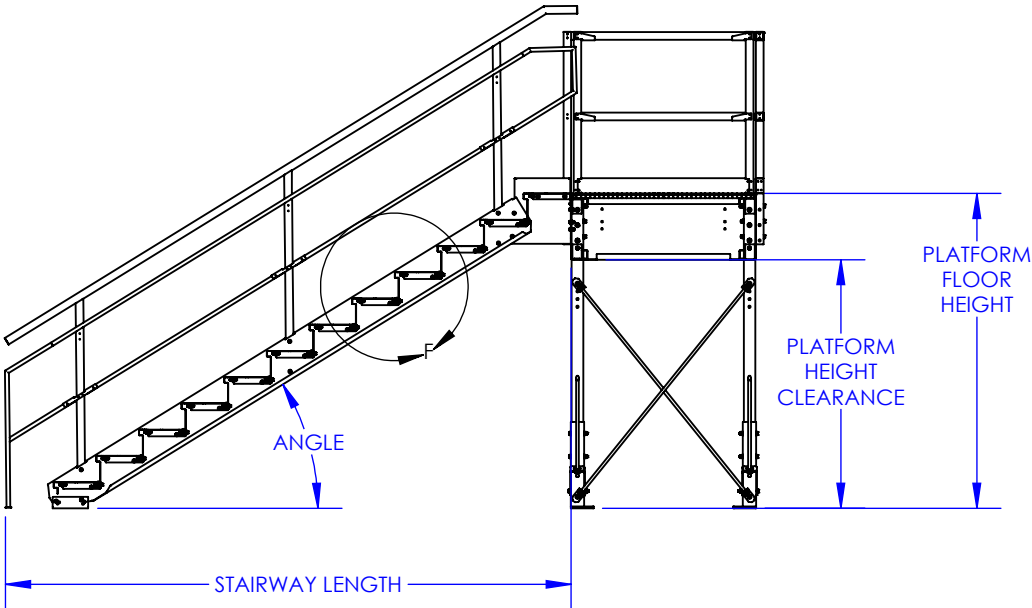

SECTION E-E

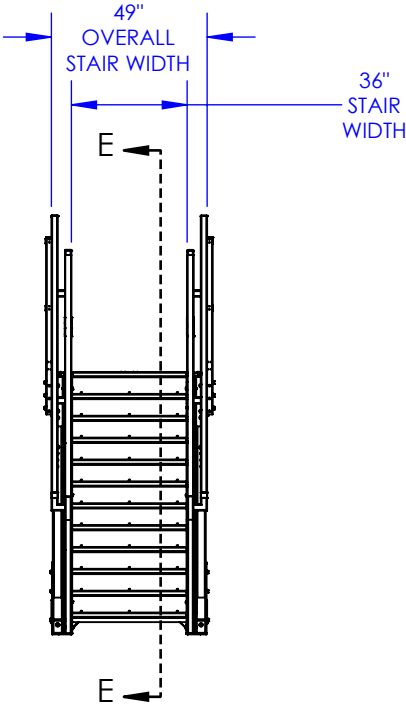

MODEL: LC2

DESCRIPTION: CONVEYOR CROSSOVER, 2-STAIRWAYS