

TOP VIEW

BETWEEN  
FRAMES

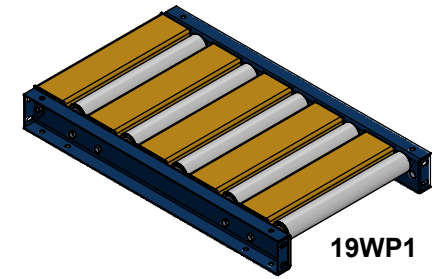

19WP1

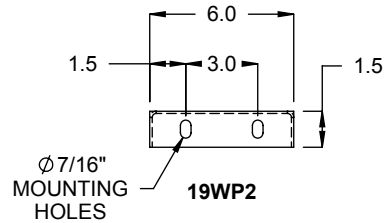
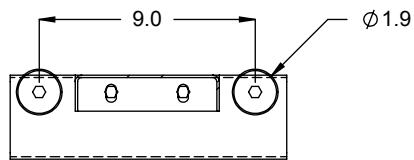
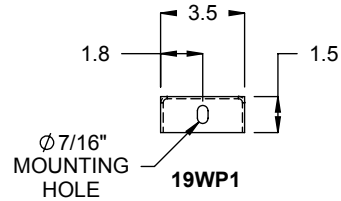
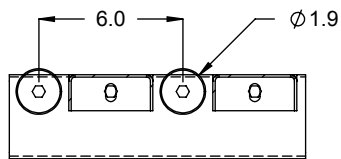
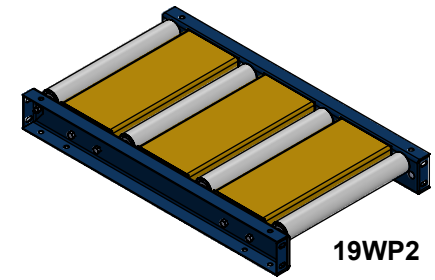

19WP2

**SPECIFICATIONS**

**BETWEEN FRAMES:** 6" - 51"

**MOUNTING:** 3/8" Hardware included.

**CONSTRUCTION:** 12ga formed steel channel with integral butt couplers.

**FINISH:** Safety yellow.

ALL PRODUCT, PRODUCT SPECIFICATIONS AND DATA ARE SUBJECT TO CHANGE WITHOUT NOTICE TO IMPROVE RELIABILITY, FUNCTION OR DESIGN OR OTHERWISE.

**Model:** 19WP1, 19WP2 - Walkover Plate for 1.9" Gravity Roller Conveyor

REV	
0	