

A40 BEARING
 LUBRICATION TYPE: OIL
 LOAD RATING: 145 LBS.
 TEMP. RATING: -40 F TO 140 F
 MAX SPEED: 200 RPM

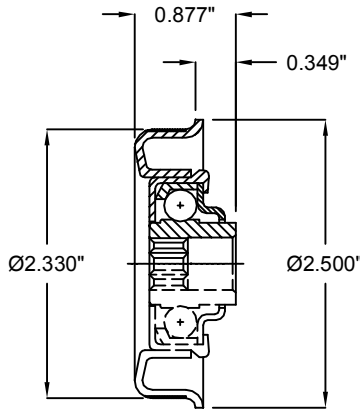

A41 BEARING
 LUBRICATION TYPE: GREASE
 LOAD RATING: 145 LBS.
 TEMP. RATING: -40 F TO 250 F
 MAX SPEED: 200 RPM

SPECIFICATIONS	
BETWEEN FRAME:	6" - 51"
ROLL CONSTRUCTION:	Round tube, 2.50" Diameter, 14 Gauge, HRPO.
BEARINGS:	<u>Standard</u> (A40) Non Precision, Oiled. <u>Optional</u> Non Precision, grease packed. All bearings with 7/16" hex axle.
AXLE RETENTION:	<u>Standard</u> 3" Spring staked one side. <u>Optional</u> cotter pins.
ROLLER SURFACE:	<u>Standard</u> Carbon Steel. <u>Optional</u> Orange Polyurethane, 1/8" wall.

Model: R2514 - Roller Assembly

REV	
0	

