

END DRIVE, RIGHT HANDSIDE (SHOWN)
LEFT HAND SIDE OPPOSITE AS SHOWN

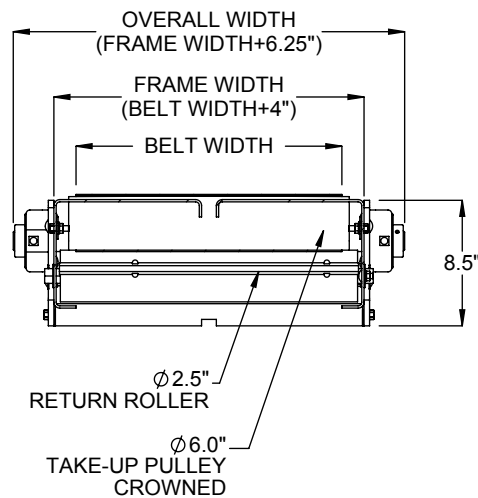

SECTION A-A
TAKE-UP END
TYP ALL DRIVES

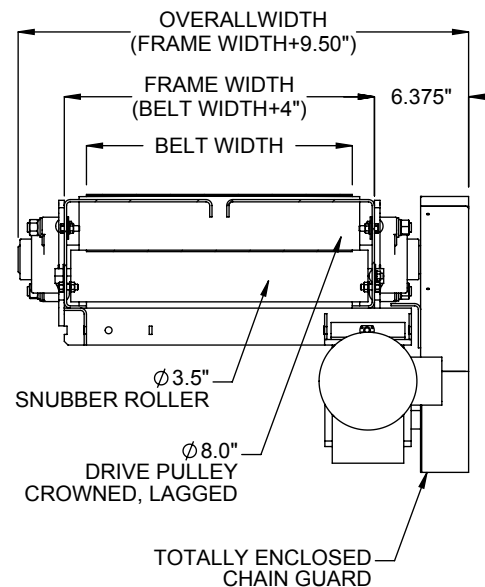

SECTION B-B
DRIVE END

SPECIFICATIONS

BEGINNING ELEVATION: 9.5" - 126"	BELT WIDTH: 12", 24", 36", 48", 60", 72"
ENDING ELEVATION: 9.5" - 126"	LENGTH: 60" - 1200"
SUPPORT CENTER: 0', 5', 10'	SPEED: 15 - 150 FPM
BELT: Standard belt is Trackmate 120 EMB with clipper lace. Optional belts include Trackmate Roughtop, PVC white, Food grade white polyurethane thermoplastic and Slip Top latex belts. V-belt construction is available.	
DRIVE: Standard drive is an End drive, right hand side. Optional drives include End drive left hand side, Side drive right or left hand side, or Center drive right or left hand side	
MOTOR: 1/2 HP through 3 HP, Voltages including 120/1/60, 230/3/60, 460/3/60 and 575/3/60, Energy efficient, DC and Inverter Duty motors also available.	
SUPPORT CENTERS: Standard supports are floor supports on 5' centers. Optional on 10' centers.	
FRAME FINISH: Standard finish is OSHA safety blue powder. Optional colors include green, beige, gray, orange, black and yellow.	

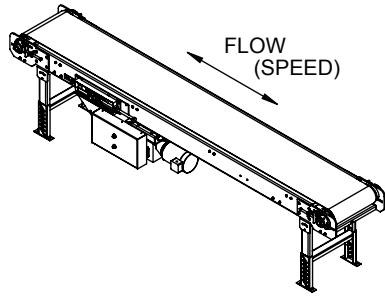

**CENTER DRIVE, RIGHT HAND SIDE (SHOWN)
LEFT HAND SIDE OPPOSITE AS SHOWN**

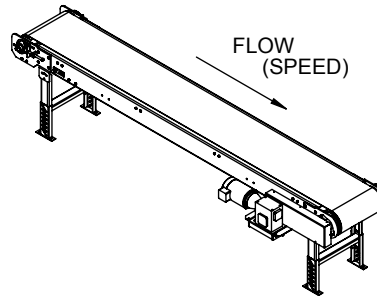

**SIDE DRIVE, RIGHT HAND SIDE (SHOWN)
LEFT HAND SIDE OPPOSITE AS SHOWN**

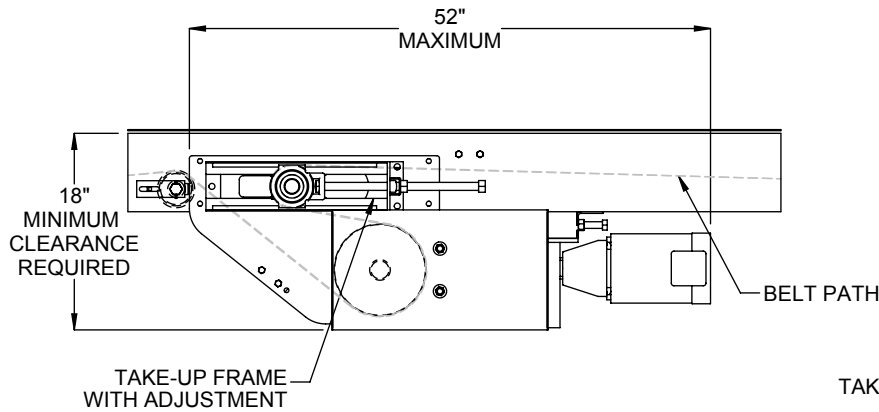

CENTER DRIVE OPTION

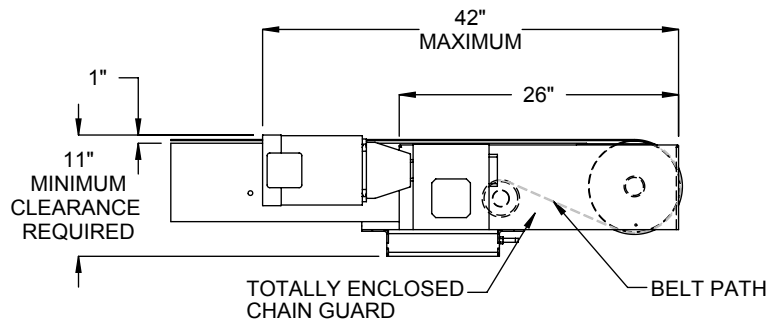

SIDE DRIVE OPTION

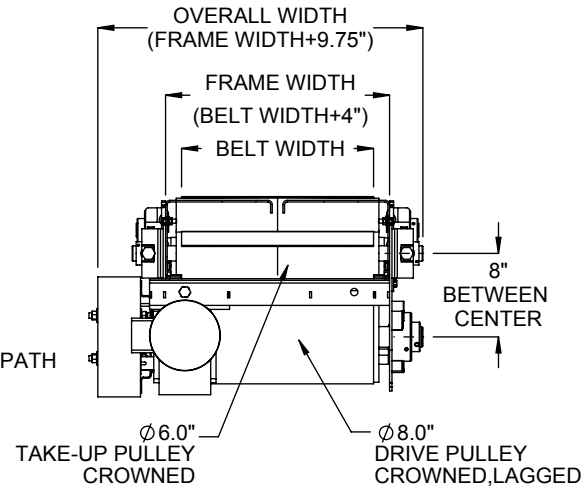

**CENTER DRIVE
END VIEW**

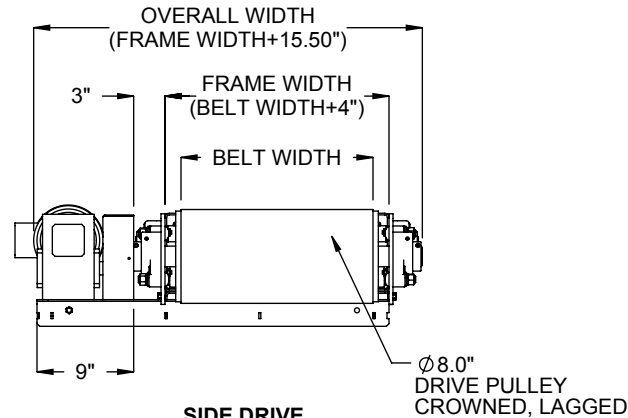

**SIDE DRIVE
END VIEW**

LOAD CAPACITY @ 60 FPM (LBS)

HP	WIDTH					
	12"	24"	36"	48"	60"	72"
3/4	440	425	410	400	385	375
1	590	580	560	550	540	525
1 1/2	900	885	870	850	840	830
2	1200	1190	1180	1160	1150	1140

LOAD CAPACITY @ 30 FPM (LBS)

HP	WIDTH					
	12"	24"	36"	48"	60"	72"
3/4	890	880	870	855	840	830
1	1190	1180	1170	1160	1150	1130
1 1/2	1800	1795	1785	1770	1760	1740
2	2420	2410	2400	2380	2370	2360

**MAXIMUM LOAD PER LINEAR FOOT OF CONVEYOR
IS 200 POUNDS - NOT TO EXCEED CAPACITY ABOVE**

GUARD RAIL OPTION

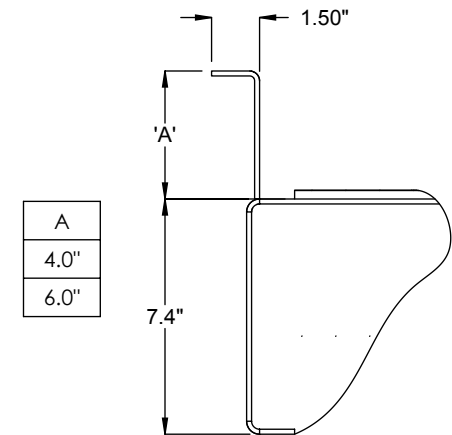

**ANGLE GUARD RAIL
WELDED TO BOTH SIDES**

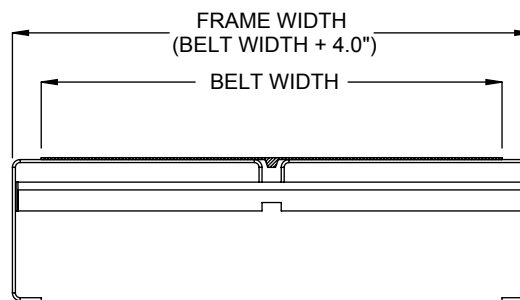

OPTIONAL V-BELT CONSTRUCTION

NOTE: PULLEYS ARE GROOVED TO ACCOMMODATE THE V-BELT